



Washington State
Department of Transportation
Paula J. Hammond, P.E.
Secretary of Transportation

Northwest Region
15700 Dayton Avenue North
P.O. Box 330310
Seattle, WA 98133-9710
206-440-4000
TTY: 1-800-833-6388
www.wsdot.wa.gov

June 30, 2010

TO: MAP Team

THRU: Liz Kriewald

FROM: Dave Lindberg
(206) 521-5624

C7553 – WMS As-built Report, Attachment B
SR 900
SE 78th St Vic to Newport Way Vic
And I-90 WB Off Ramp - Widening
Contract 7553

Dear Ms. Kriewalk:

Attached for your review and inter agency processing is the Lake Sammamish State Park, Wetland Mitigation Site As-built report.

Should you have any questions, please contact Brett Thompson at (206) 521-5623.

Sincerely,

A handwritten signature in blue ink, reading "David Lindberg".

David V. Lindberg, P.E.
PROJECT ENGINEER
999 3rd Ave., Suite 2424
Seattle WA 98104

DVL / bet
Attachment: Attachment B

cc: File 4D
Day File



**Washington State
Department of Transportation**

**Wetland Mitigation Site
As Built Report**

SR 900

**SE 78th ST to Newport Way Vicinity
And I-90 WB Off Ramp - Widening**

**Washington State Department of Transportation
Northwest Region, King County Area
Water Quality Certification Order #5317
Corps Reference# NWS-2007-29-SOD**

**Acting Project Environmental Inspector
Brett E. Thompson
June 23, 2010
Wetland Mitigation Site**

**Washington State Department of Transportation
Northwest Region, King County Area
Water Quality Certification Order #5317
Corps Reference# NWS-2007-29-SOD**

Table of Contents

Background Information

C7553 - Development (Impact) Site

Site Directions – Vicinity Map

C7553 – Compensatory (Mitigation) Site

Construction Schedule

Mitigation Site Parameters

Construction Notes

WMS Compensatory – Site Plan Sheets

Plant Material List

WMS Compensatory – As-built Plan Sheets

WMS Permanent Photos

Interagency Agreements / Easement

**Washington State Department of Transportation
Northwest Region, King County Area
Water Quality Certification Order #5317
Corps Reference# NWS-2007-29-SOD**

Background Information

1. **Project Name:** SR900 SE 78th to Newport Way VIC and I-90 WB Off Ramp Widening
2. **DOE Docket and COE Reference:** WQCO# 5317 and COE# NWS-2007-29-SOD
3. **Wetland Mitigation Contact Information:**

(a) **Applicant:** Washington State Department of Transportation
Dave Lindberg Construction Office, (206) 521-5624
999 Third Avenue, Suite 2424
Seattle, WA 98104-4019

(b) **Landowner:** Washington State – Lake Sammamish State Park
Washington State Park and Recreation Commission
(425) 455-7010

(c) **Onsite Wetland Professionals:** WSDOT Biologist, Colleen Kroe (206) 440-4902
WSDOT Landscape, Alisa Sawich (206) 440-4515
WSDOT Biologist, Brian Bigler (206) 440-4519

4. **Wetland Mitigation Report Author** WSDOT Biologist, Trina Miller (206) 440-4901
5. **Wetland Mitigation Team** WSDOT (NWR) Dayton ENV/Landscape Support
6. **Wetland Mitigation Report Date** Approved February 2008

Development (Impact) Site

7. Project Description:

This project widens SR900 by adding one lane in each direction from SE 78th Street to Newport Way (MP 20.09 to 21.08), plus adds turn lanes for intersection capacity, widens Tibbets Creek Bridge 900/29, widens WB I-90 Off Ramp, and rebuilds and upgrades existing signals and signal inter-connect systems. In addition, the project provides pervious sidewalk, wetland, storm water and other environmental mitigation. Fish passage barriers are repaired at MP 20.09 and 20.34. The net result is increased traffic capacity with improved operations in a high accident location.

(a) Site Directions: See the Vicinity Map attachment

From Seattle via EB I-90: Drive east to exit #15 and follow the signs to SR900. Turn right at the signal onto SR 900 and stay in the west bound lanes. Do not take the two left lanes that provide access to the Issaquah Park and Ride. The project begins at the intersection with Newport Way and continues up the hill to SE 78th near Clay Pit Creek. There is EB and WB lane widening throughout the development corridor.

**Washington State Department of Transportation
Northwest Region, King County Area
Water Quality Certification Order #5317
Corps Reference# NWS-2007-29-SOD**

(b) Project Development Start and Finish Date: Start Date: August 2008
Finish Date: July 2010

Note: Plant establishment is the remaining bid item work.

(c) Development Area (acres) and type(s) of Wetlands impacted:

Briefly, WSDOT mitigated for impacts to creeks and tributaries, wetlands and streams throughout the SR900 development footprint.

The Tibbetts Creek Bridge was widened approximately 20 feet on each side. Two new box culverts, 50 feet and 100 feet in length, replaced two existing box culverts at Clay Pit Creek and West Fork of Tibbetts Creek. Channel enhancements included stream and habitat upgrades. In-stream and buffer habitat loss was mitigated by adding 280 linear feet of Tributary B with a 50 foot buffer enhancement.

On Wetlands, the project permanently filled 0.73 acres of Ecology Category 2 and 3 palustrine scrub-scrub and emergent wetlands. Project roadway widening and ramp improvement impacted Wetlands 1, 3, and 5-9. Temporarily impacts were 0.12 wetland and 0.73 wetland buffer acres.

On Streams, the project permanent and temporary impacts to channel habitat are 0.02 and 0.05 acres. This project will permanently and temporarily impact buffer 0.91 and 0.28 acres. The permanent impacts include channels culverted to accommodate project widening. Restoration work at West Fork Tibbetts and Tributary B will result in improved fish passage and habitat.

Compensatory (Mitigation) Project

8. Description: Bounded Parcel# 20240690002

Temporary and permanent impacts are identified in the Development (Impact) section above. The wetland mitigation site is located at Lake Sammamish State Park and bounded by Tributary 0178A and Issaquah Creek, Parcel# 20240690002. (No changes to the original approved plan)

(a) Site Directions: See preceding the Vicinity Map attachment

Wetland Mitigation Site Location: On the edge of the city of Issaquah, Washington in King County. It is located on the southeast shores of Lake Sammamish.

Park Address: Lake Sammamish State Park
2000 NW Sammamish Road
Issaquah, WA 98027

From Seattle via EB I-90: Drive east to exit #15, and follow the signs to the SE 56th Lake Sammamish State Park parking lot. Follow the access parking lot trail to the area bounded between Tributary 0178A and Issaquah Creek as shown on the Vicinity Map sheet V1

(b) Who completed WMS project: See section 3C for WSDOT Team contacts

Wetland Mitigation Site
Washington State Department of Transportation
Northwest Region, King County Area
Water Quality Certification Order #5317
Corps Reference# NWS-2007-29-SOD

(c) Actual Acreage and Mitigation Type Authorize:

The project will mitigate by creating 1.74 and enhancing 0.11 acres primarily of scrub scrub wetland to mitigate for 0.75 acre impacts to palustrine emergent wetlands. Enhancement of 516 linear feet of Tributary 0178A will mitigate for culverted and project storm water conveyance. 2.23 acres of buffer around the LSSP site will mitigate the remaining development impacts.

(d) Project Mitigation Start and Finish Dates:

Start Date: August 2008
 Finish Date: July 2010

9. Compensatory (Mitigation) Construction Changes: No Changes, See Section 11 for a description of remaining and as-built work, construction notes and contract plan sheets.

10. Compensatory (Mitigation) Change Description: N/A

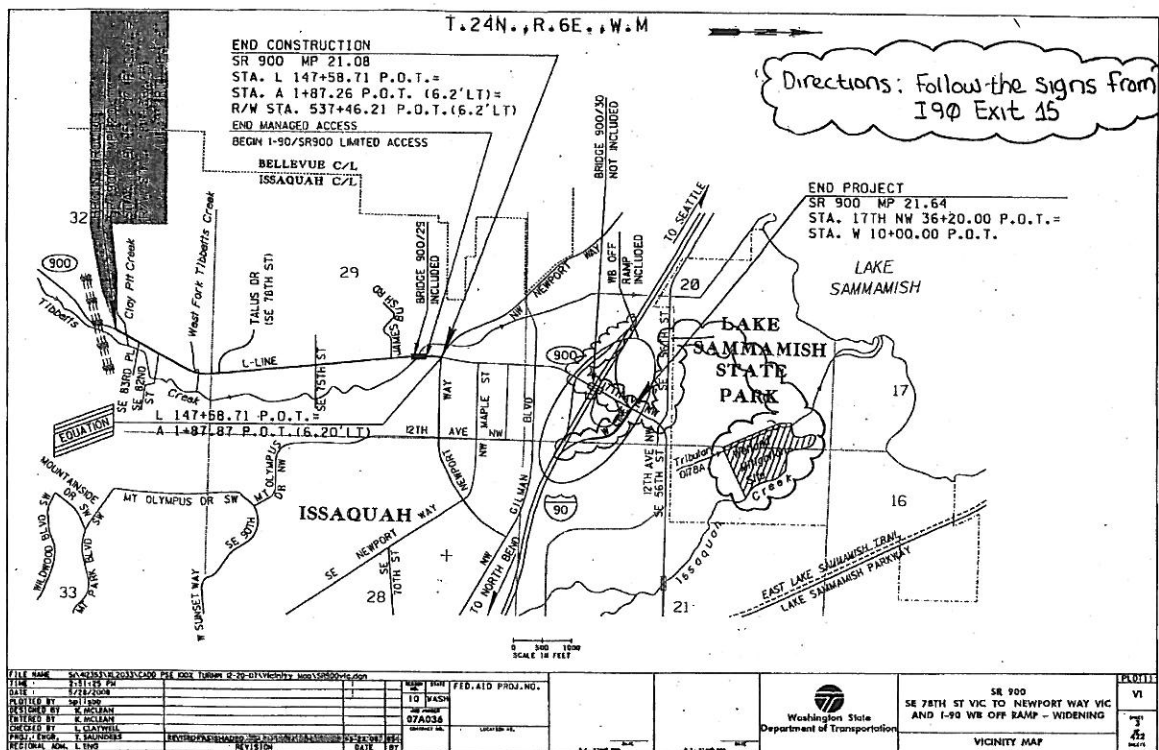

Vicinity Map

**Wetland Mitigation Site
Washington State Department of Transportation
Northwest Region, King County Area
Water Quality Certification Order #5317
Corps Reference# NWS-2007-29-SOD**

(11) WMS follow up actions: Plant establishment and site monitoring.

WMS As-built Construction Schedule:

Date	Work Activity
3/27-3/28/09:	HVF is in place – TESC walkthrough – Maintenance repairs
7/28-7/30/09:	WMS Pre-Construction Checks at Tributary 0178A - Fish exclusion meeting and fish exclusion operations. (sandbag & fishnet) All review and agency checks were approved prior to work.
8/5-8/7/09:	Erect Tributary 0178A Stream Diversion by fabricating backflow and primary (upstream) dams, set primary and diversion pipe with pumps, wrap in plastic and weigh down by gravel bags. Conduct WMS site clear and grub, inspect BMPs, maintain HVF and prevent track out. Bid item work: 2 Clear & Grub and 220 Stream Diversion
8/10-8/21/09:	Contour grading, haul spoils off site, and emplace wattles along HVF adjacent to Tributary 0178A and monitor water quality. Inspect all BMPs, maintain HVF and sweep site entrances to prevent track out. Bid item work: 38 Mitigation Site Excavation and 171 Wattle
8/24/09:	WSDOT Inter-discipline Team site meeting on channel and contour work. Quality control measures set with minor channel staking changes agreed upon to meet design intent as shown in the contract plans.
8/25-8/31/09:	Icon Subcontractor “Watershed Solutions” mobilizes onto site, upgrades egress and access roads to prevent site degradation. Soil amendment material import to stockpile, mix, with fine compost, wood chip placement and select contour grading done. WSDOT landscape makes a follow up quality control visit. Bid item work: 173 EWPC, 216 Fine Compost, 218 Soil Amendment and 219 Bark-Mulch.
9/01-9/08/09:	Icon constructs log and log with rootwad for in channel work with debris pile placement. WSDOT landscape makes a follow up quality control visit with as-built log placement map made. Bid item work: 222 Log w/ Rootwad and 356 Log

**Wetland Mitigation Site
Washington State Department of Transportation
Northwest Region, King County Area
Water Quality Certification Order #5317
Corps Reference# NWS-2007-29-SOD**

WMS As-built Construction Schedule Continued:

9/15-9/18/09: Watershed Solutions does hydroseed, coir fabric placement and coarse compost work. Second WSDOT Inter-discipline Team meeting to discuss quality control measurement, confirm and verify all WSDOT actions meet permit compliance.

Bid item work: 48 Coir Mat Blanket, 173 EWPC, 178 Wet Native Seed and 219 Bark-Mulch

9/24-9/25/09: Remove stream diversion and equipment; take daily water quality samples, inspect BMPs, maintain HVF and sweep construction site entrances to prevent track out.

Bid item work: 220 Stream Diversion

11/13/09: Inspect BMPs and maintain HVF

Bid item work: 173 Erosion Water Pollution Control (EWPC)

12/18/09: PSIPe inspection and layout at Lake Sammamish State Park soccer field. Plant areas MD3 and ME2 and cover unplanted WMS plants in sawdust. WSDOT landscape makes a quality control visit. Inspect BMPs, site entrances, and maintain HVF. Begin and complete planting areas MB1, MC1 and MD2.

Bid item work: 173 EWPC, 180-204 PSIPe

1/2/10: Complete PSIPe layout and planting at WMS. A follow up quality control check indicates some plants and live stakes were not planted to standards. A second follow up visit is scheduled.

Bid item work: 180-204 PSIPe

1/19/10: Follow up WMS PSIPe inspection and work is now complete.

Bid item work: 180-204 PSIPe

3/1/10 WSDOT ECI site visit to WMS

4/19/10: WSDOT ECI site visit to WMS indicates minor storm damage with fallen trees and bark erosion in landscape planting areas.

**Wetland Mitigation Site
Washington State Department of Transportation
Northwest Region, King County Area
Water Quality Certification Order #5317
Corps Reference# NWS-2007-29-SOD**

WMS As-built Construction Schedule Continued:

4/26-5/7/10: Two Rail Post Fence installation has already begun. The Icon Subcontractor is "Appearance Fence" is nearly complete except for post hole spoils and site clean-up. All exposed soils will be raked out and dressed with bark mulch.

Bid item work: 312 Two Rail Post and Rail Fence

5/17/10: Icon Subcontractor "Haines" completes herbicide spraying at WMS landscape planting areas.

Bid item work: Included activity in 180-204 PSIFE work

5/26-6/9/10: Access road "trail" quarry spall and hog fuel removal. Emplace straw bales and wattles at low spots. Prep site for turn back agreement. Appearance Fence is back to rake out spoils and dress work area. Inspect BMPs and site entrances to prevent track out. HVF maintenance, hydroseed, dress and cover with straw.

The WSDOT Landscape Engineer made a follow up quality control site visit.

Bid item work: 170 Straw, 172 Wattle, 173 EWPC & 179 Seed

**Wetland Mitigation Site
Washington State Department of Transportation
Northwest Region, King County Area
Water Quality Certification Order #5317
Corps Reference# NWS-2007-29-SOD**

(12) Final Impact and Compensatory Site Maps - Construction Notes

(a) Development (Impact) and Compensatory (Mitigation) Construction Notes:

1. Locations of sampling and monitoring sites: Water quality measurements were taken to meet permit obligations during all stream construction activities. This was a standard and reportable practice for both the development and compensatory project work.
2. Six water quality monitoring sites found on the SR 900 were routinely tested and input into the WSDOT water quality database for dissemination to the DOE.
3. Wetland site location: The Wetland Mitigation Site (WMS) is located adjacent in Lake Sammamish State Park between Tributary 0178A and Issaquah creek. The total footprint is 4.0 acres clearing and grubbing with an additional 0.5 acres select clearing, grubbing and pruning totaling 4.5 acres.
4. Plan deviations and changes did not happen during WMS construction.
 - The Engineer and WSDOT Multi-disciplinary Team formed a combined teams approach to ensure contract plan, construction, quality control and reference check built was built into the work.
 - The final WMS contour map is complete includes an as-built versus design check. As-built sheets are attached in Section 12f for review.
 - WSDOT Landscape and Construction Office will insure site maintenance and dead plant replacement prior to first year plant establishment. Second and third year plant establishment will be contingent upon meeting all PSIP requirements.

(12a) WMS Geographic Location: The wetland mitigation site is located at Lake Sammamish State Park and bounded by Tributary 0178A and Issaquah Creek. There were no changes to the original approved plan. Please see the contract plans below and Sections 8C and 13 for additional information – Thank you

(12) WMS Compensatory Site Contract Plan Sheets Below:

Wetland Mitigation Site
Washington State Department of Transportation
Northwest Region, King County Area
Water Quality Certification Order# 5317
Corps Reference# NWS-2007-29-SOD

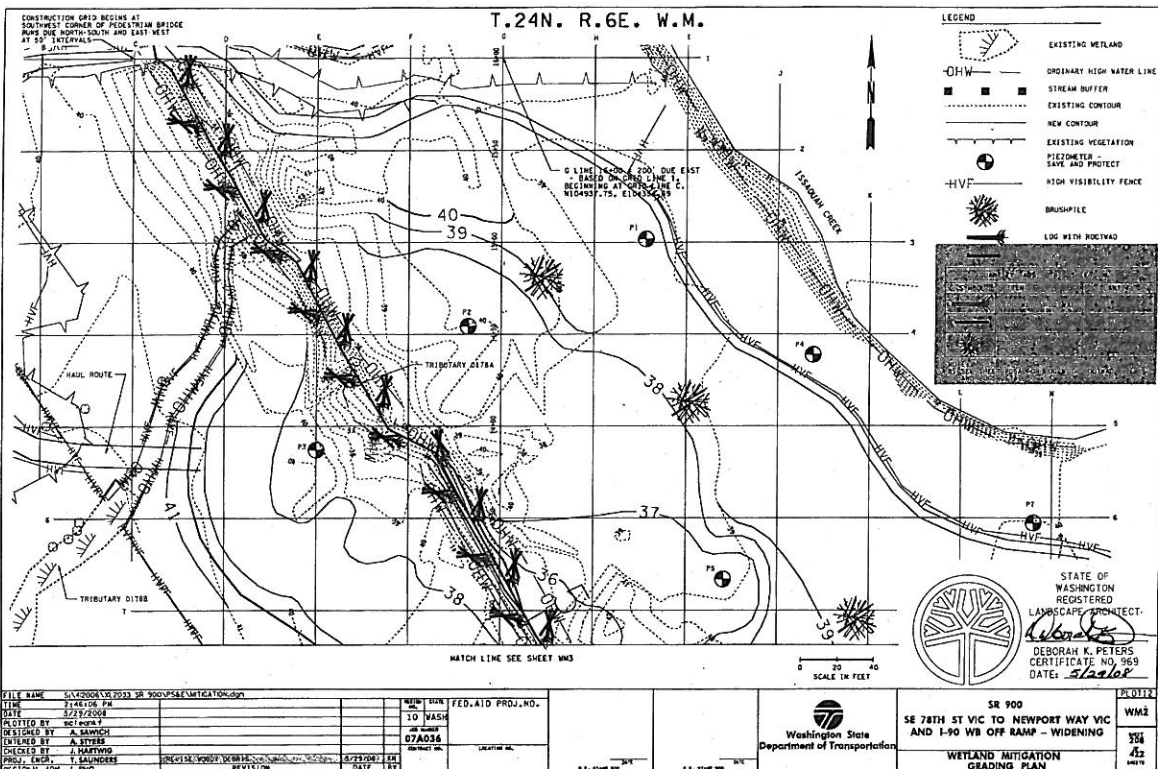
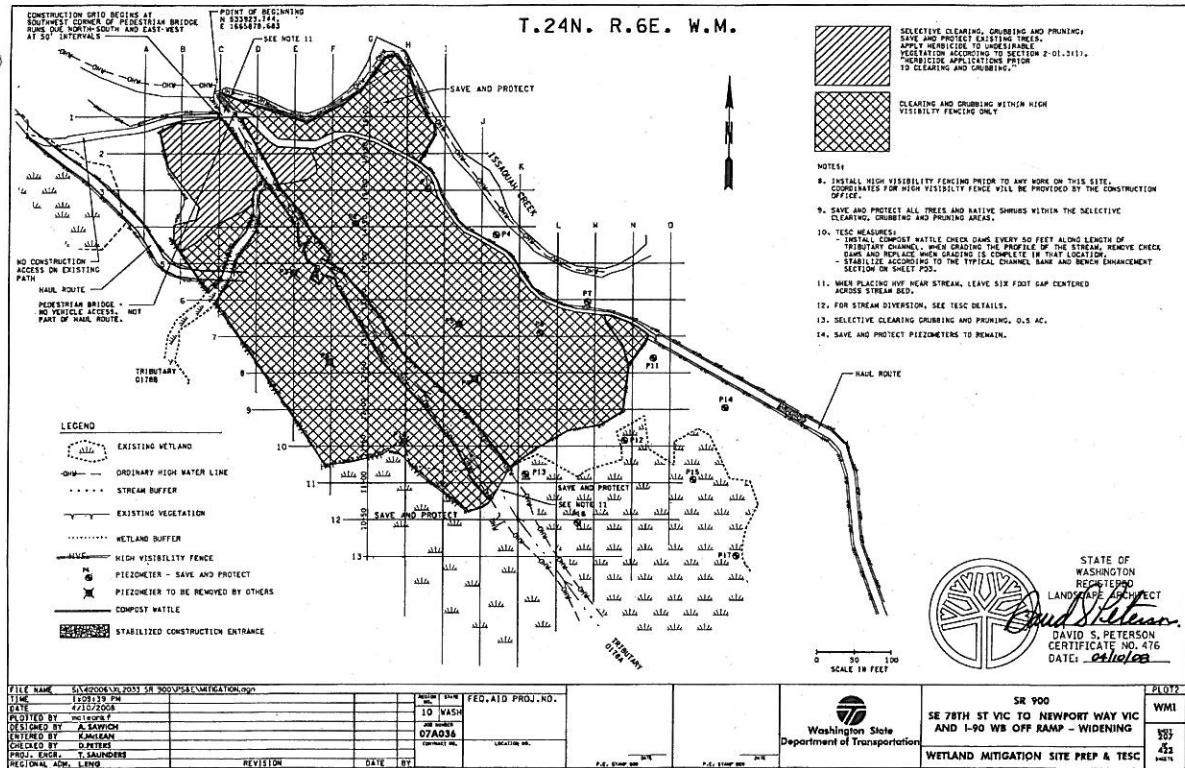

(12 b-e) WMS Compensatory Site Contract Plan Sheets Continued:

Wetland Mitigation Site
Washington State Department of Transportation
Northwest Region, King County Area
Water Quality Certification Order# 5317
Corps Reference# NWS-2007-29-SOD

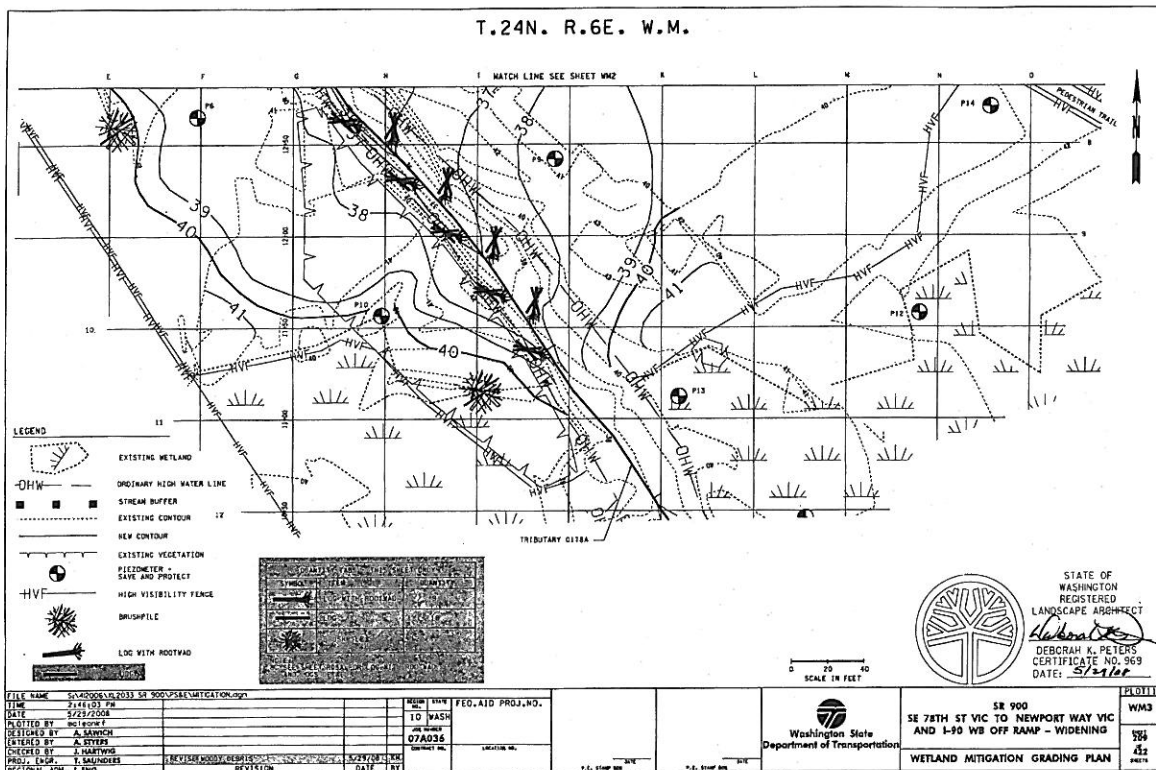

GRADING SCHEDULE FOR WETLAND MITIGATION SITE
 FOR GRID AND GRADING PLAN SEE SHEETS WM2 AND WM3

STATION G. LINE	OFFSET	ELEVATION	STATION G. LINE	OFFSET	ELEVATION
11+02.2	148.96' RT	40	13+54.43	18.08' LT	34
11+19.4	142.65' RT	39	13+58.07	117.77' RT	39
11+25.31	144.96' RT	38	13+59.48	16.01' LT	36
11+28.46	159.56' RT	39	13+66.55	35.08' LT	37
11+28.12	172.40' RT	40	13+75.46	39.15' LT	36
11+29.10	141.83' RT	38	13+79.71	27.83' LT	35
11+38.12	131.98' RT	41	13+84.69	42.09' LT	35
11+44.96	20.86' LT	41	13+85.32	36.74' LT	34
11+59.70	40.59' RT	40	13+85.63	34.41' LT	34
11+63.58	55.26' RT	40	14+00.45	175.52' LT	41
11+71.21	47.79' LT	41	14+35.83	138.10' LT	39
11+83.75	231.08' RT	41	14+39.34	143.43' LT	40
11+89.34	105.97' RT	37	14+45.90	105.04' LT	38
12+14.60	209.05' RT	40	14+51.86	52.37' RT	39
12+42.95	57.11' RT	36	14+95.05	77.67' LT	38
12+50.13	13.07' RT	35	15+15.56	7.03' RT	40
13+03.00	148.00' LT	41	15+16.37	73.04' LT	39
13+52.55	9.55' LT	37	15+22.63	61.72' LT	40

STATE OF WASHINGTON
 REGISTERED
 LANDSCAPE ARCHITECT
 DAVID S. PETERSON
 CERTIFICATE NO. 976
 DATE: 04/23/08

Washington State
 Department of Transportation

SR 900
 SE 78TH ST VIC TO NEWPORT WAY VIC
 AND I-90 WB OFF RAMP - WIDENING

WM4
 125
 42
 SHEETS

FILE NAME: S:\4000\16033 SR 900\WMS\MITIGATION.dgn
 TIME: 11:42:06 AM
 DATE: 4/22/08
 PLOTTED BY: STEVEN
 DESIGNED BY: A. JARVON
 ENTERED BY: A. JARVON
 CHECKED BY: J. HARTWIG
 PROJ. ENGR. T. SANDERS
 REGIONAL ADM. L. BING

REVISION: DATE BY

WMS PROJ. NO. 07A036
 LOCATION: SR 900
 CONTRACT NO. 07A036

(12 b-e) WMS Compensatory Site Contract Plan Sheets Continued:

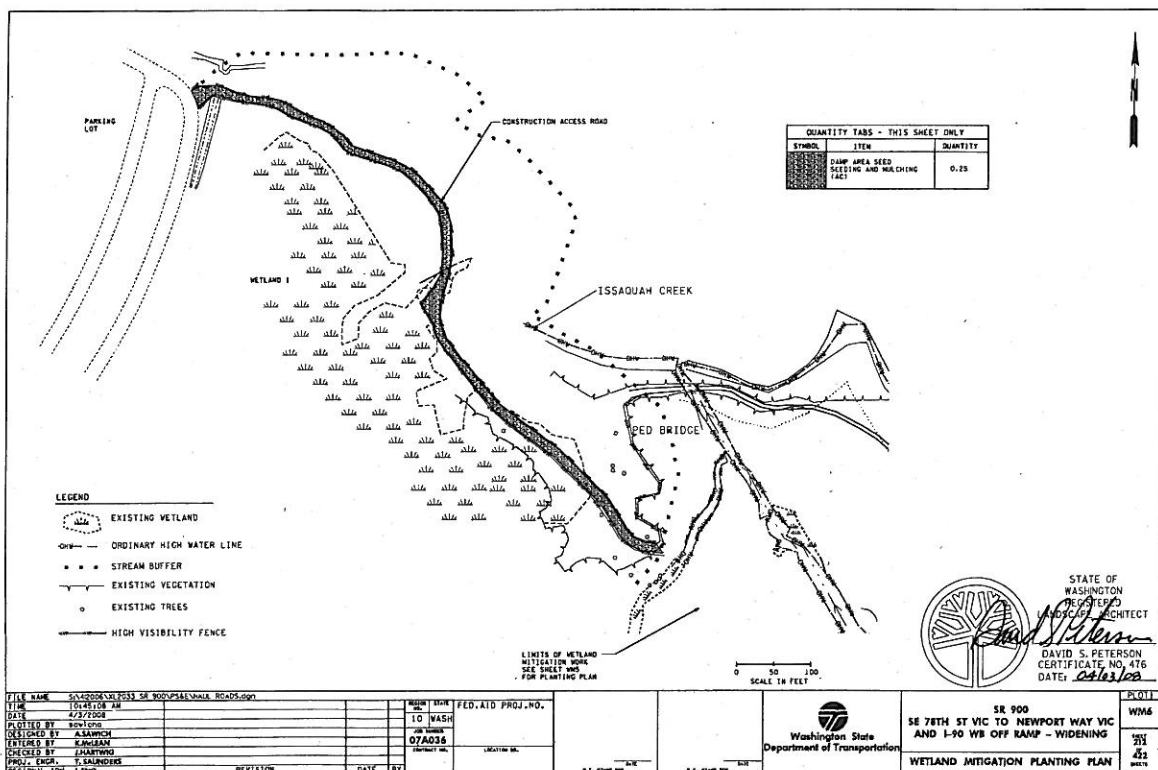
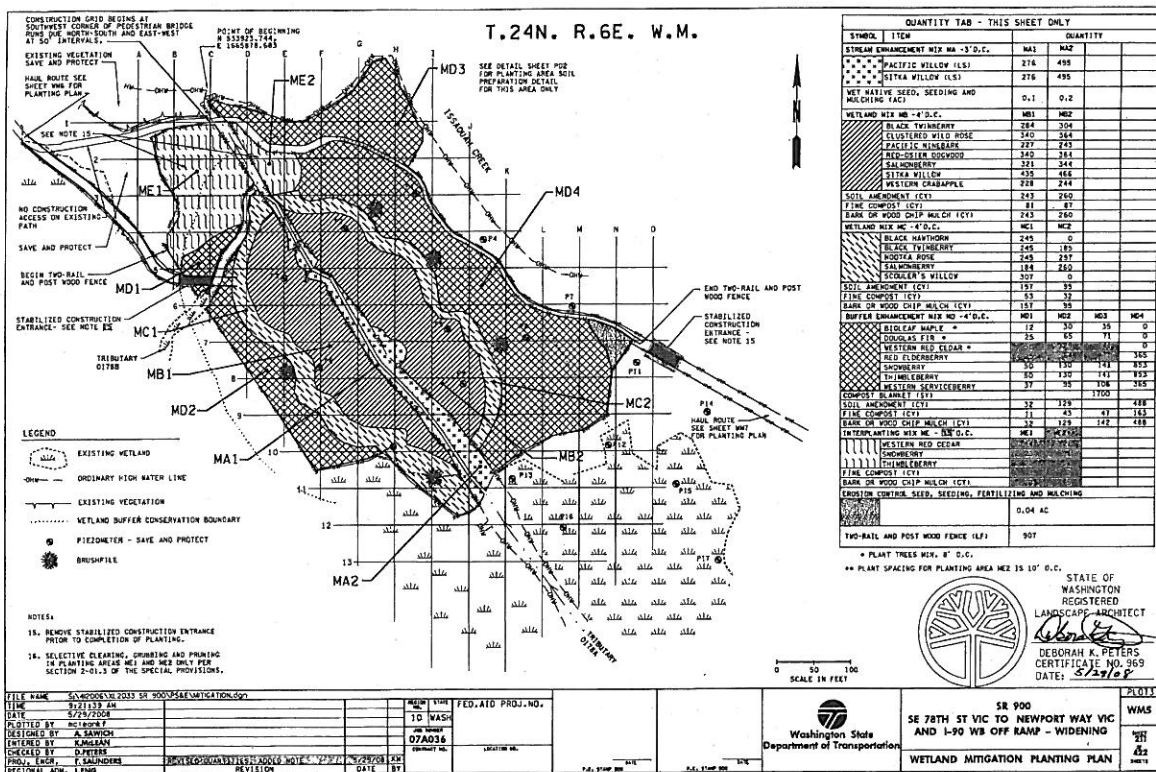

QUANTITY TABS - THIS SHEET ONLY

SYMBOL	ITEM	QUANTITY
[Stippled Area]	CAMP AREA SEED BEDS AND MULCHING TACI	0.64

LEGEND

- [Stippled Area] EXISTING WETLAND
- ORDINARY HIGH WATER LINE
- • • STREAM BUFFER
- EXISTING VEGETATION
- EXISTING TREES
- HIGH VISIBILITY FENCE

PROJECT INFORMATION

FILE NAME: S:\4000\40033 SR 900\SR900\WMA_Roads.dgn
 DATE: 10/24/13
 DESIGNED BY: [blank]
 CHECKED BY: [blank]
 PROJECT: T. LAUNDERS

WETLAND MITIGATION PLANTING PLAN

SR 900
 SE 78TH ST VIC TO NEWPORT WIC
 AND I-90 WB OFF RAMP - WIDENING

DAVID S. PETERSON
 CERTIFICATE NO. 476
 DATE: 10/24/13

WASHINGTON STATE
 Department of Transportation

SCALE: 1" = 100'

NOTES:

1. IF A CONFLICT OCCURS BETWEEN THE AMERICAN STANDARD FOR NURSERY STOCK AND THESE SPECIFICATIONS, THEN THESE SPECIFICATIONS SHALL APPLY.
2. SPECIFICATIONS FOR SIZE AND CONDITION ARE MINIMUM.
3. ALL PLANT MATERIALS SHALL BE NURSERY GROWN STOCK.
4. PLANTS SHALL BE RANDOMLY MIXED THROUGHOUT EACH PLANTING ZONE AS APPROVED BY THE ENGINEER. SEE SCHEDULE FOR MIN. GROUPINGS OF EACH SPECIES.
5. ALL TREES REQUIRING STAKING SHALL BE STAKED AND SECURED WITHIN 48 HOURS AFTER PLANTING.
6. ALL TREES/SHRUB PLANTINGS SHALL BE SET BACK A MIN. OF 5 FEET FROM ALL PAVEMENT EDGES, EXCEPT WHERE NOTED. (SEE SETBACK CHART ON SHEET P02)

[illegible]

(12 b-e) WMS Compensatory Site Contract Plan Sheets Continued:

Wetland Mitigation Site
Washington State Department of Transportation
Northwest Region, King County Area
Water Quality Certification Order #5317
Corps Reference# NWS-2007-29-SOD

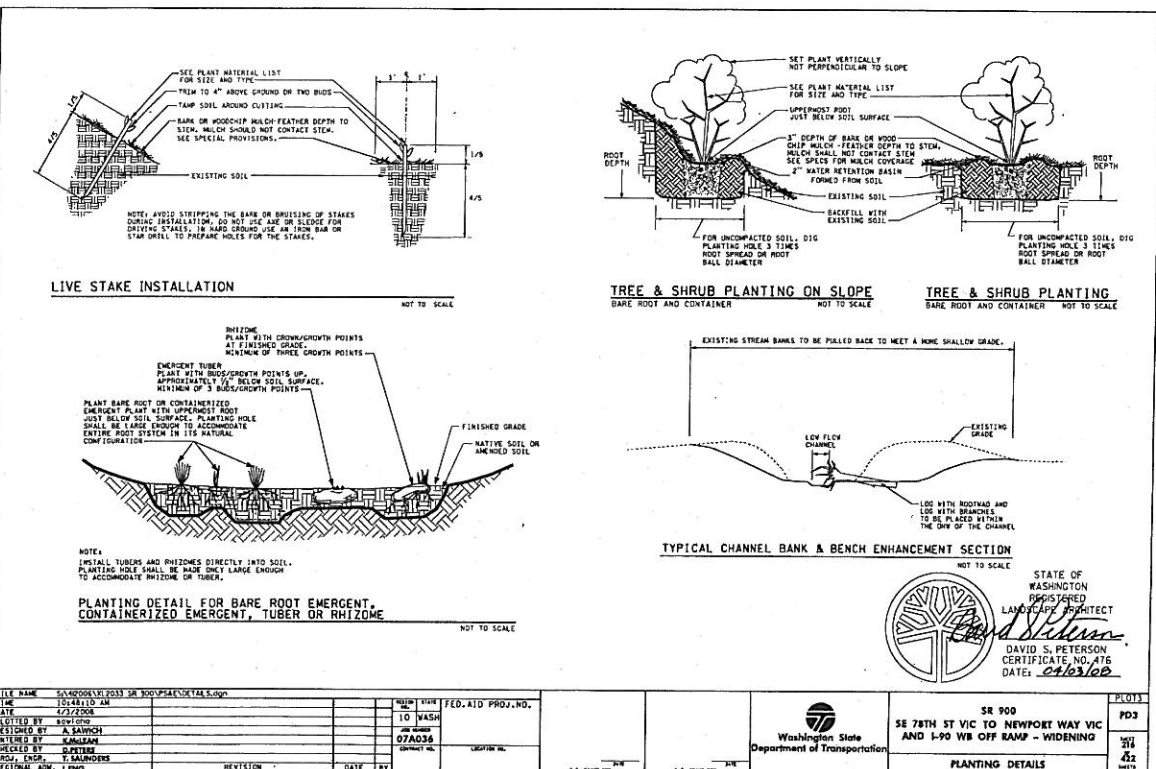
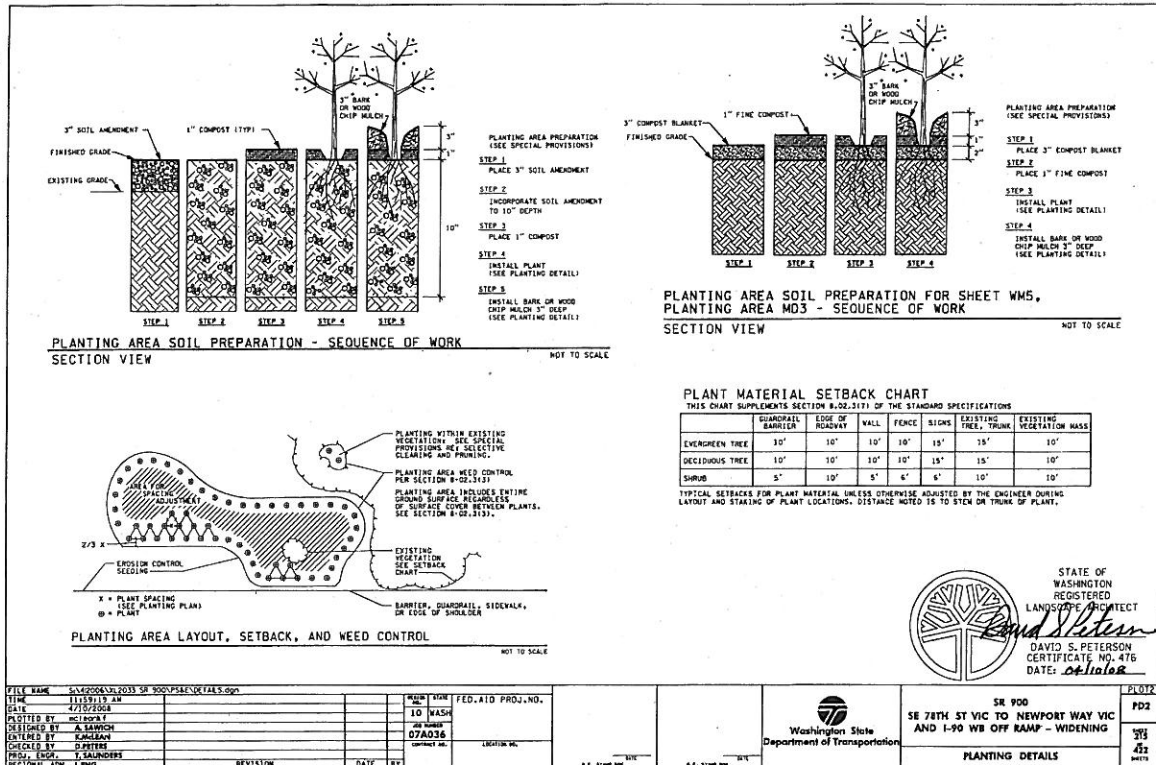

Wetland Mitigation Site
Washington State Department of Transportation
Northwest Region, King County Area
Water Quality Certification Order# 5317
Corps Reference# NWS-2007-29-SOD

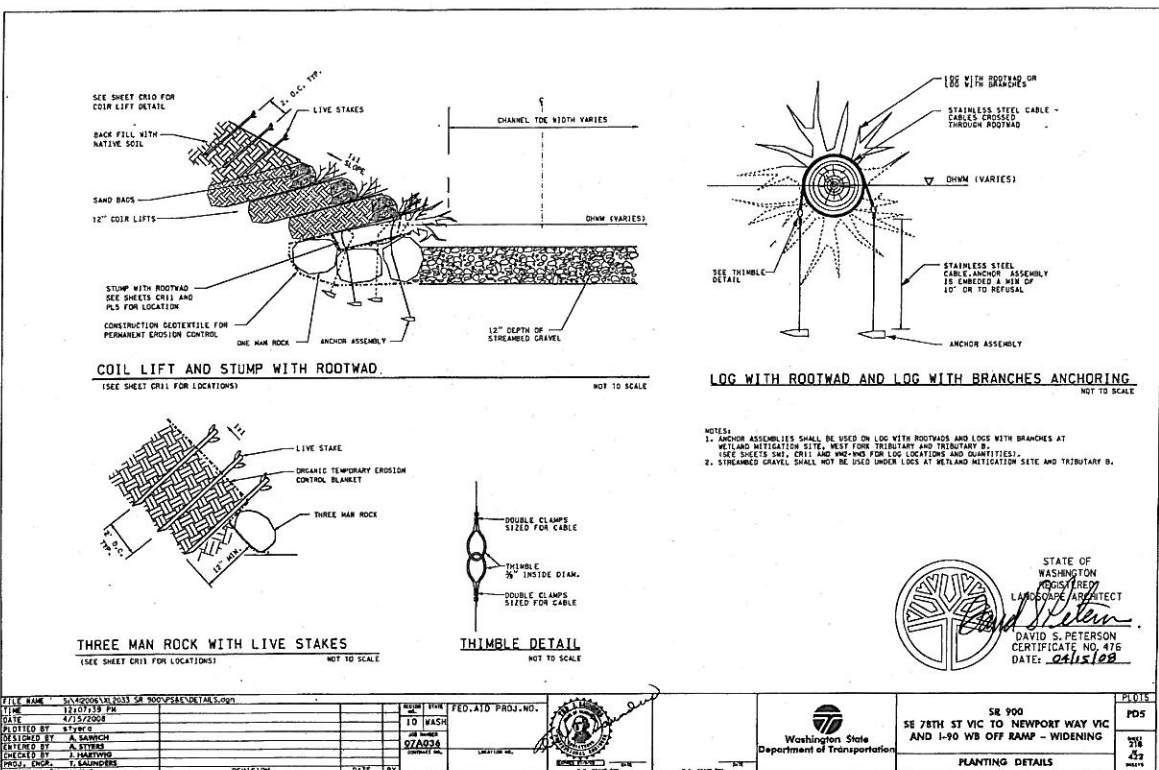
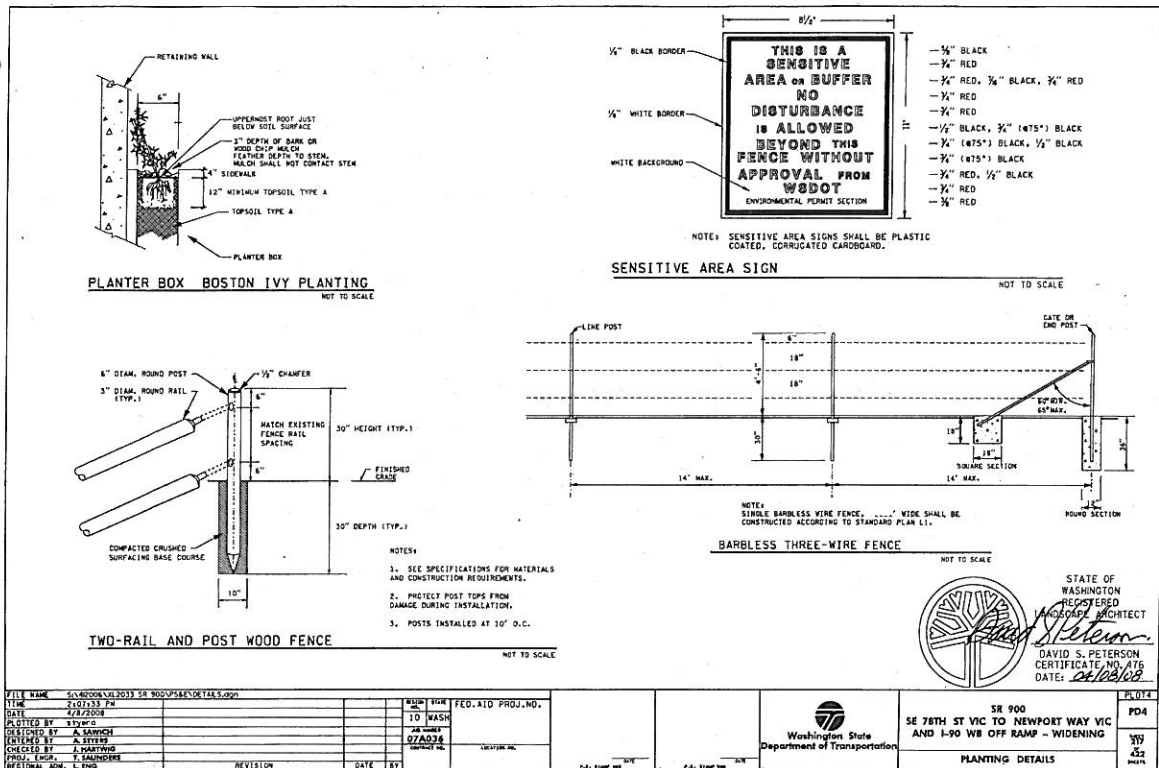

(12 b-e) WMS Compensatory Site Contract Plan Sheets Continued:

Wetland Mitigation Site
Washington State Department of Transportation
Northwest Region, King County Area
Water Quality Certification Order# 5317
Corps Reference# NWS-2007-29-SOD

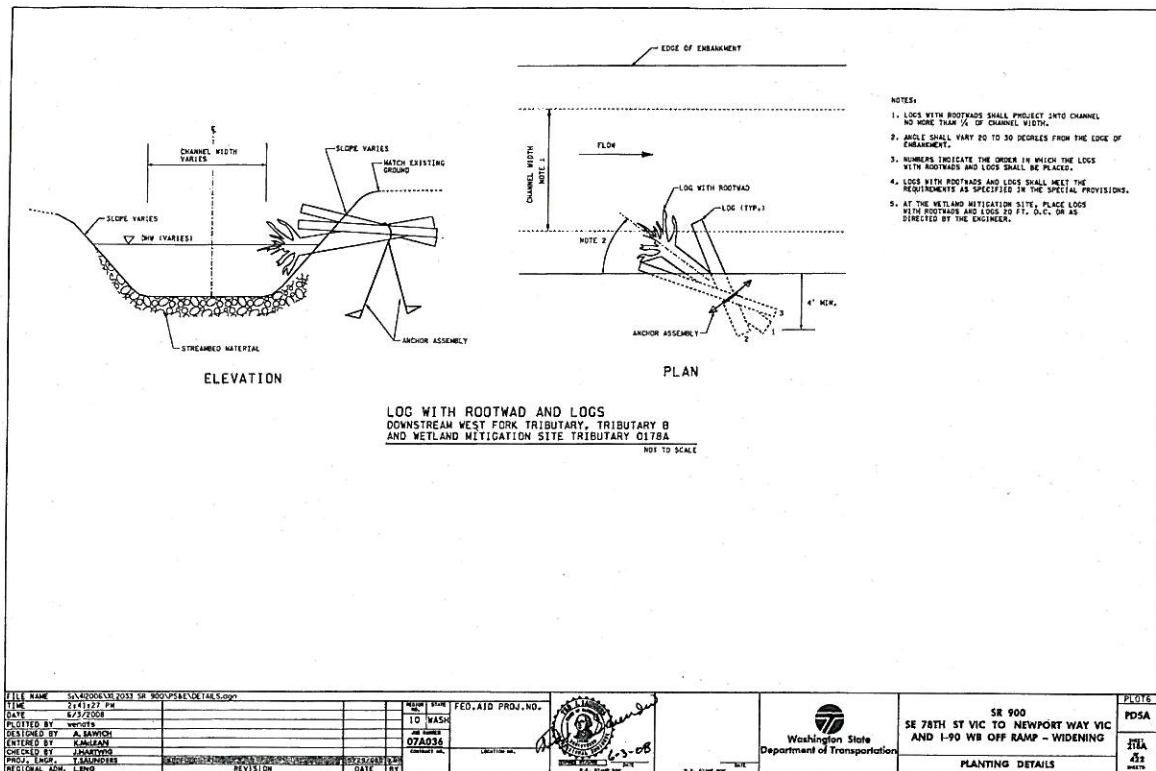

WMS Planting Plan Table Extract

Quantity Tab Takeoff	Plan Quantity	Plan Quantity	Plan Quantity	Plan Quantity
Stream Enhancement – 3 ft Off Center	MA1	MA2		
Pacific Willow, Live Stake	276	495		
Sitka Willow, Live Stake	276	495		
Wetland Mix MB – 4 ft Off Center (OC)	MB1	MB2		
Black Twinberry	284	304		
Clustered Wild Rose	340	364		
Pacific Nine Bark	227	243		
Red-Osier Dogwood	340	364		
Salmonberry	321	344		
Sitka Willow	435	466		
Western Crabapple	228	244		
Soil Amendment (CY)	243	260		
Fine Compost (CY)	81	87		
Bark or Wood Chip Mulch (CY)	243	260		

Quantity Tab Takeoff	Plan Quantity	Plan Quantity	Plan Quantity	Plan Quantity
Wetland Mix MC – 4 ft OC	MC1	MC2		
Black Hawthorn	245	0		
Black Twinberry	245	185		
Nootka Rose	245	297		
Salmonberry	184	260		
Scouler's Willow	307	0		
Soil Amendment (CY)	157	95		
Fine Compost (CY)	53	32		
Bark or Wood Chip Mulch (CY)	157	95		
Buffer Enhancement Mix MD – 4 ft OC	WD1	WD2	WD3	WD4
Bigleaf Maple *	12	30	35	0
Douglas Fir *	25	65	71	0
Western Red Cedar *	50	129	141	0
Red Elderberry	25	64	71	365
Snowberry	50	130	141	853
Western Serviceberry	37	95	106	365
Compost Blanket (SY)			1700	
Soil Amendment (CY)	32	129		488
Fine Compost (CY)	11	43	47	163
Bark or Wood Chip (CY)	32	129	142	488
Interplanting Mix ME – 15 ft OC	ME1	ME2**		
Western Red Cedar	44	21		
Snowberry	21	11		
Thimbleberry	21	11		
Fine Compost (CY)	3	2		
Bark or Wood Chip Mulch (CY)	10	5		
Erosion Control Seed, Fertilize & Mulch	0.04 AC			
Two Rail & Post Wood Fence (LF)	907			
* Plant Tree minimum 8ft OC				
** Plant Spacing Area ME2 10ft OC				

WMS Planting Plan - C Plan Sheet Extract

(12f) WMS Site Mitigation Review: As-built survey was done during June 2010. The pan photo location is marked by hub, lathe and ribbon located on high ground at landscape area ME2.

(12 b-f) WMS Compensatory Site Contract Plan Sheets Continued:

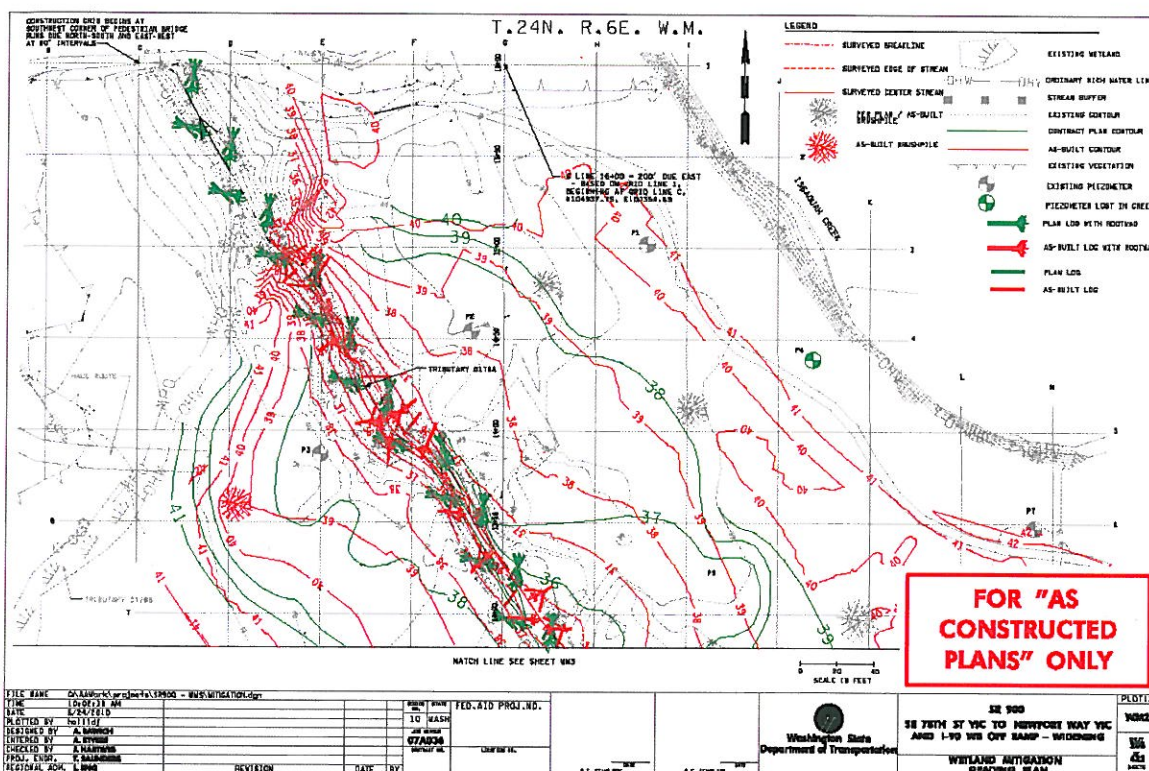

**Wetland Mitigation Site
Washington State Department of Transportation
Northwest Region, King County Area
Water Quality Certification Order #5317
Corps Reference# NWS-2007-29-SOD**

As-Built WMS Permanent Pan Photo

(13) Permanent Photo Station



Comment: Location is the western knoll in landscape area ME2

(13) Permanent Site Photos Continued:

**Wetland Mitigation Site
Washington State Department of Transportation
Northwest Region, King County Area
Water Quality Certification Order #5317
Corps Reference# NWS-2007-29-SOD**

As-Built WMS Permanent Pan Photo

(13) Planting Area MD3



Comment: Looking (East) from the permanent photo station

(13) Permanent Site Photos Continued:

**Wetland Mitigation Site
Washington State Department of Transportation
Northwest Region, King County Area
Water Quality Certification Order #5317
Corps Reference# NWS-2007-29-SOD**

As-Built WMS Permanent Pan Photo

(13) Planting Area MD3 & MD4



Comment: Looking (East-Southeast) from the permanent photo station

(13) Permanent Site Photos Continued:

**Wetland Mitigation Site
Washington State Department of Transportation
Northwest Region, King County Area
Water Quality Certification Order #5317
Corps Reference# NWS-2007-29-SOD**

As-Built WMS Permanent Pan Photo

(13) Planting Area MB2, MC2 & MD4



Comment: Looking (East-Southeast) from the permanent photo station

(13) Permanent Site Photos Continued:

**Wetland Mitigation Site
Washington State Department of Transportation
Northwest Region, King County Area
Water Quality Certification Order #5317
Corps Reference# NWS-2007-29-SOD**

As-Built WMS Permanent Pan Photo

(13) Planting Area MB2, MC2, MD4 & MA1



Comment: Looking (South) from the permanent photo station

(13) Permanent Site Photos Continued:

**Wetland Mitigation Site
Washington State Department of Transportation
Northwest Region, King County Area
Water Quality Certification Order #5317
Corps Reference# NWS-2007-29-SOD**

As-Built WMS Permanent Pan Photo

(13) Planting Area MB1-2, MC2, MD4 & MA1



Comment: Looking (South-Southwest) from the permanent photo station

(13) Permanent Site Photos Continued:

**Wetland Mitigation Site
Washington State Department of Transportation
Northwest Region, King County Area
Water Quality Certification Order #5317
Corps Reference# NWS-2007-29-SOD**

As-Built WMS Permanent Pan Photo

(13) Planting Area MC1, MD1 & ME1



Comment: Looking (South-Southwest) from the permanent photo station

(13) End Permanent Site Photos

**Wetland Mitigation Site
Washington State Department of Transportation
Northwest Region, King County Area
Water Quality Certification Order #5317
Corps Reference# NWS-2007-29-SOD**

(14) Agreements & Conservation Easements

Interagency Agreement on Tributary 0178A "Pickering Ditch" & WMS Mitigation Work

After recording, return document to:

Washington State Parks &
Recreation Commission
Lands program
PO Box 42650
Olympia, WA 98504-2650

*Document Title: Restrictive Covenant
Reference Number of Related Document: N/A
Grantor(s): Washington State Parks and Recreation Commission
Grantee: Public
Legal Description: Ptn of Section 20, Township 24 North, Range 6 East, W.M.
Additional Legal Description is on Page 3 of Document
Assessor's Tax Parcel Number: 20240690002*

**RESTRICTIVE COVENANT
PICKERING DITCH – WSDOT RESTORATION PROJECT
LAKE SAMMAMISH STATE PARK**

The grantor herein, **Washington State Parks and Recreation Commission** owns and operates Lake Sammamish State Park, through which Pickering Ditch flows into Issaquah Creek. All of Pickering Ditch lies within the park, located in Section 20, Township 24 North, Range 6 East, W.M., King County.

It is the purpose of this Restrictive Covenant to prevent certain practices in the use of grantor's land which might be inconsistent with the continued viability of the Pickering Ditch restoration area as shown in the attached Exhibits A and B.

With Parks' permission granted in an Interagency Agreement #O986000DOT1 dated May 9, 2008, the Washington State Department of Transportation (WSDOT), will enhance and maintain a portion of Pickering Ditch within Lake Sammamish State Park. This area is shown as exhibits "A" & "B" attached hereto.

It is the purpose of this restrictive covenant to prevent certain practices in the use of Parks' land which might be inconsistent with the continued viability of the Pickering Ditch restoration area.

NOW, THEREFORE, the grantor agrees and covenants that said restoration area shall remain as constructed by WSDOT. However, Parks may allow, propose and/or perform future enhancement of the Pickering Ditch restoration area if (i) enhancement is imposed

(14) Agreements & Conservation Easements Continued:

(14) Agreements & Conservation Easements Continued:

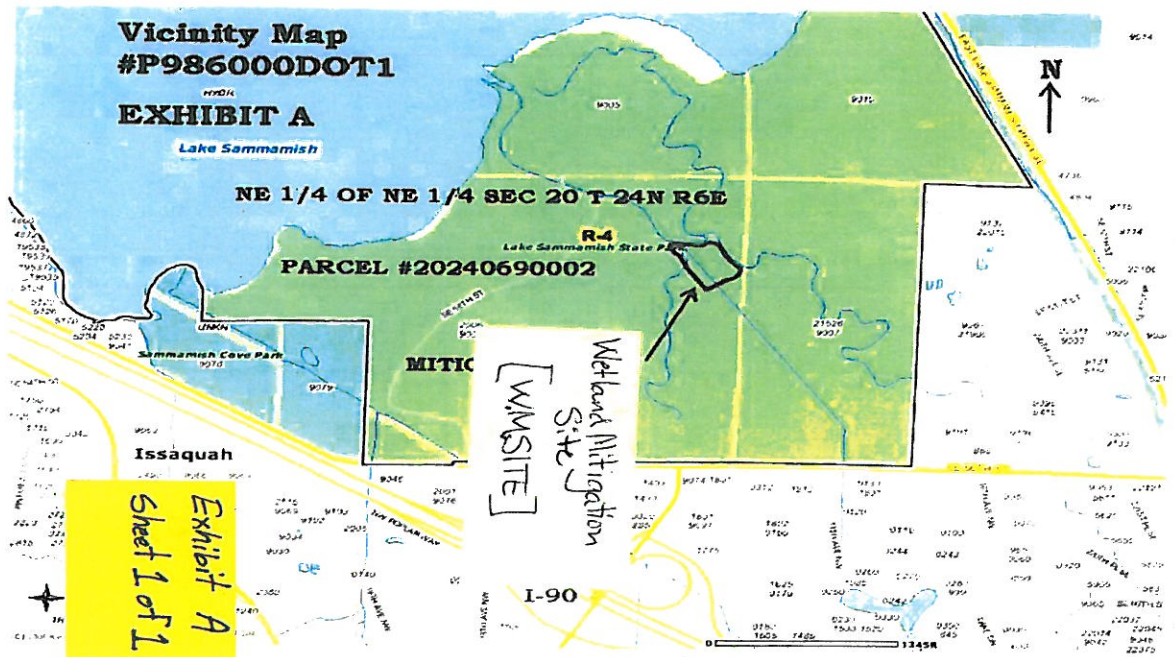

(14) End Agreements & Conservation Easements